

No.	Item	Symbol	Unit	Specification	No.	Item	Symbol	Unit	Specification
1	Drive	-	-	Retangular Wave	13	Rotor Inertia	J-M	kg-cm <sup>2</sup>	18.62 ± 10%
2	Cooling Method	-	-	Totally Enclosed	14	Rated Power Rate	Q-R	Kw/s	110.2
3	Exciting Method	-	-	Permanent Magnet	15	Resistance	Ra	Ω	1.19 ± 10%/2 φ
4	Resolution	-	-	NOTE2.	16	Inductance	L	mH	8.44 ± 10%/2 φ
5	Rated Output	P-R	W	1.5KW	17	Mech Time Constant	T <sub>m</sub>	ms	0.74 ± 10%
6	Rated Torque	T-R	N-m	14.327	18	Elect Time Constant	T <sub>e</sub>	ms	7.09 ± 10%
7	Max. Torque	T-max	N-m	42.963	19	Insulation Class	-	-	Class B
8	Rated Speed	N-R	rpm	1000	20	Operation Temp.	T	°C	0~40
9	Rated Current	I-R	A	7.45	21	Operation Humid.	RH	%	<90
10	Max. Current	I-max	A	22.35	22	Storage Temp.	T	°C	-20~-60
11	Torque Constant	Kt	N-m/A	2.123 ± 10%	23	Storage Humid.	RH	%	<90
12	Back emf (at 1800rpm)	Vemf	Volts	230 ± 10%/2 φ	24	Weight	W	kgw	16.75

**Notes:**  
**1. Motor to be IP67 (excluding the shaft opening & connectors)**  
**2. Encoder TYPE: 2500ppr, 8192ppr 17bit, 15bit**

Military connector  
 MSS3102A20-15P

Military connector  
 MSS3102A20-18P

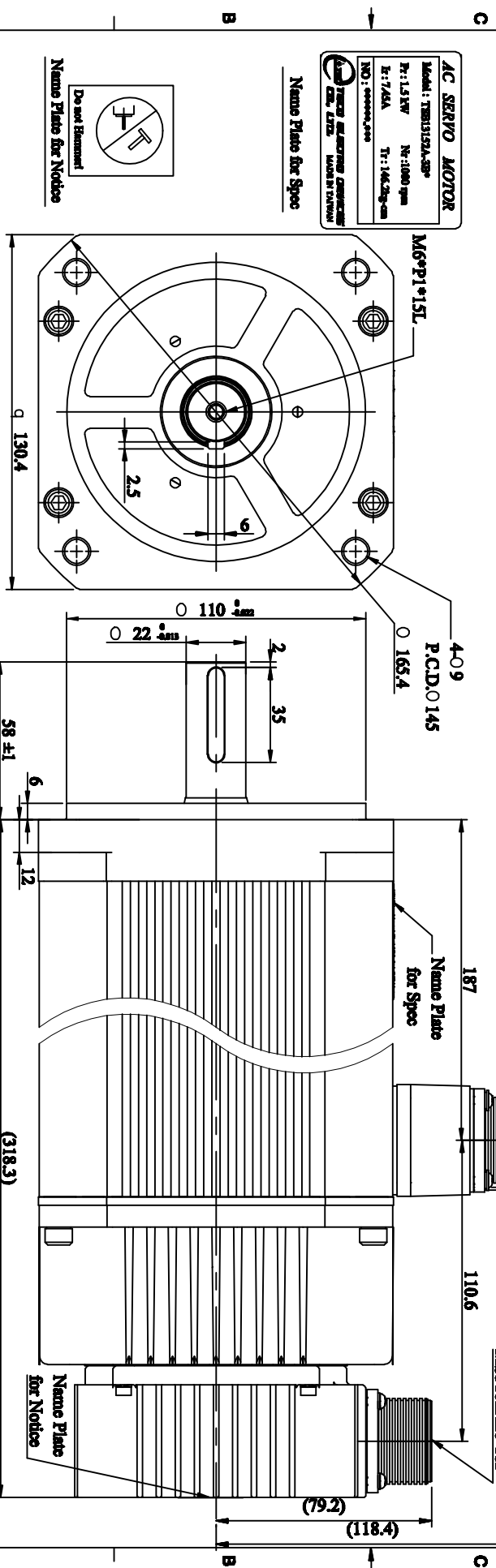

STANDARD TOLERANCE	APVD	SCALE	1/3	UNIT	m m	NAME	Servo Motor Outline Drawing
X #0.5	CHKD	3RD AP				TSB13152A-3B*	
X #0.2	CHKD						
XX #0.05	DWN						
ANGLE ±30'							
MATERIAL	REV / DESCRIPTION	SIGNATURE	DATE				

Signature: Michale 03-06-13  
 Date: 03-06-13

Dept. Design DWG. NO. DTSB13152A3B\*